

PART LIST

Ref#	Description	Part#	QTY
1	Hexagon bolt with flange screw (M6X25)		12 pcs
2	26" Cabinet frame	47280	2 pcs
3	Pipe ( 30X30mm )	47284	2 pcs
4	Truss head screw ( M6X12, stainless )		16 pcs
5	26" Hanger board	47376	2 pcs
6	Pipe ( 60X30mm )	47283	1 pc
7	HEX socket head cap screw ( M8X20 )		12 pcs
8	26" Skirting board	47289	2 pcs
9	52" SS work plate	47383	1 pc
10	26" Closet side board	47389	1 pc

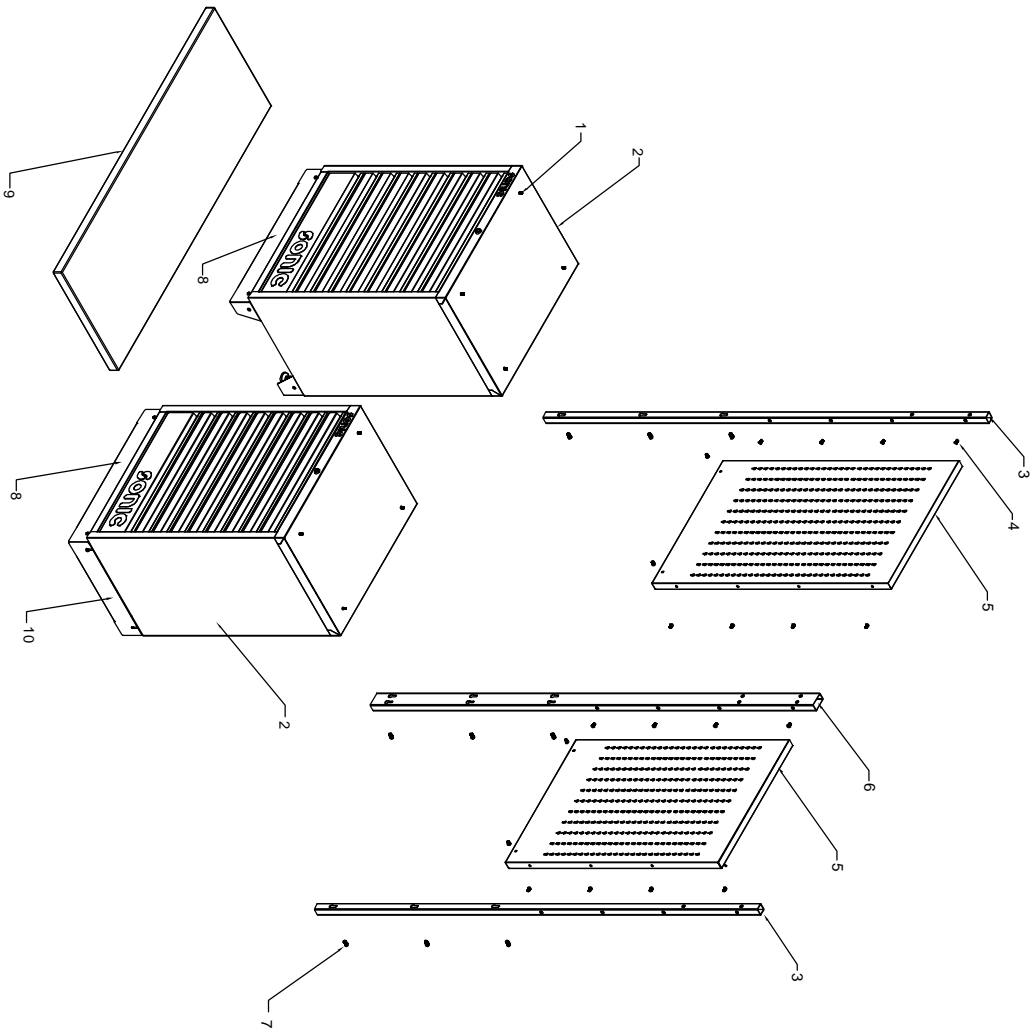

**ASSEMBLY INSTRUCTIONS**

**1. INSTALL PIPES**

Simply position the pipes over the holes on the cabinets and attach with the bolts provided. Tighten HEX socket head cap screws( M8X20) securely.

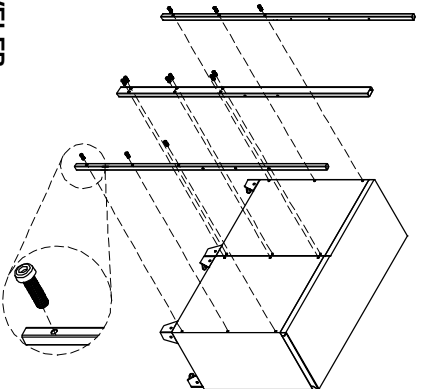

**3. ADJUST LEVELER**

Adjust the levelers and make the whole unit to stable state.

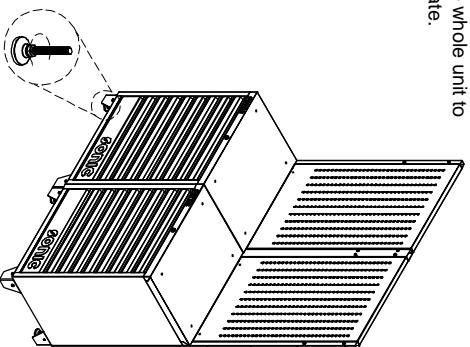

**2. INSTALL HANGER BOARD**

Simply position the hanger board over the holes and attach with the bolts provided. Tighten truss head screws(M6X12, stainless) securely.

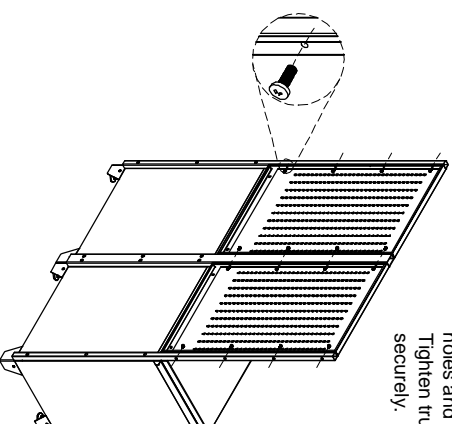

**4. PRE-DRILL HOLES OF SS WORK PLATE**

Pre-drill eight small holes under the SS work plate for easily installing. Repeat the steps for the back of SS work plate(only four holes).

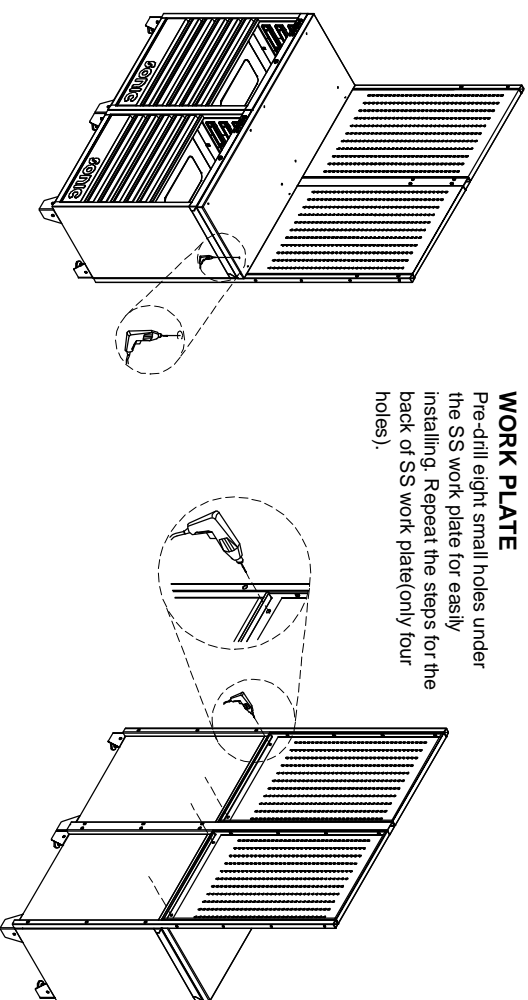

**ASSEMBLY INSTRUCTIONS**

**5. INSTALL SS WORK PLATE**

Position the SS work plate on the top of cabinets. Remove the top drawer of cabinet. Insert the Hexagon bolt with flange screw(M6X25) through the top of cabinet, and into the bottom of the SS worktop. Tighten securely. Reinstall the drawers.

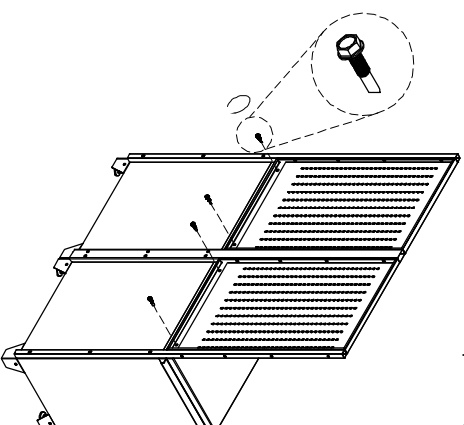
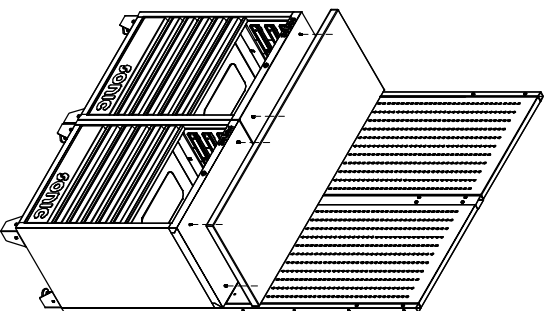

Insert the Hexagon bolt with flange screw(M6X25) through the back of hauger boards, and into the side of SS work plate. Tighten securely.

**6. INSTALL SKIRTING BOARDS**

Position the skirting boards on the legs of cabinets. Insert the truss head screw ( M6X12,stainless ) through the legs. Tighten securely. Repeat the steps for other skirting boards.

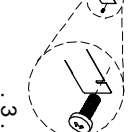
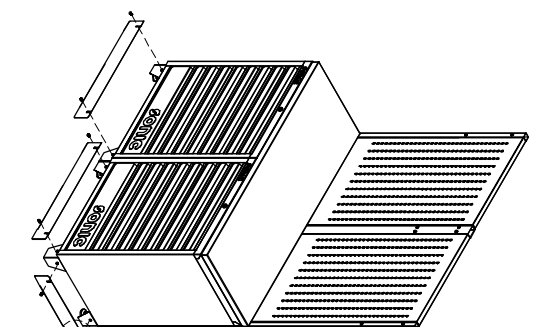

3.

