

Applications

Make	Model	Year	Type
Peugeot	1007	2005-2010	Hdi 4x2 Hdi Dangel 4x2 Hdi Dangel 4x4 Hdi Hdi 16V
	107	2005-2010	
	206/+i/CC	1999-2011	
	307	2001-2008	
	207/CC	2006-2010	
	3008	2009-2011	
	308/CC	2007-2011	
	5008	2009-2010	
	Partner/III/	1999-2012	
	Partner Origin/Ranch I/II	1999-2012	
	306	1999-2002	
	307/CC	2001-2009	
	406	1999-2006	
	607	2000-2011	
	Boxer/II	2001-2006	
	807	2005-2010	
	Expert III	2004-2012	
	508	2011-2015	
	308/CC	2007-2011	
	407/Coupe	2004-2011	
	807	2002-2010	
Citroën	407	2005-2011	Hdi 16V
	C3 I/II/First/Classic	2002-2010	
	Dispatch/Jumpy I/II	1999-2007	
	C4 Picasso/Grand Picasso	2006-2012	
	C5 II	2007-2008	
	Xsara	1999-2000	Hdi 16V
	C5	2000-2004	

Engine Code	
1.4	DV4TD (8HX), DV4TD (8HZ), DV4TD (8HT), 8HW (DV4TD), 8HV (DV4TED4), 8HY (DV4TED4)
1.6	DV6TED4 (9HZ), DV6TED4 (9HZ), DV6TED4 (9HY), DV6ATED4 (9HX), DV6ATED4 (9HW), DV6TED4 (9HW)
2.0	DW10TD (RHY), DW10UTD (RHV), DW10UTD4 (RHK), RHZ (DW10ATED/L3), DW10ATED (RHS), RHS (DW10ATED), DW10ATED4 (RHM), DW10ATED4 (RHW), DW10ATED4/L4 (RHT), DW10ATED4 (RHR), RHX (DW10ATED/L3), RHL (DW10ATED4), RHL (DW10ATED4)
2.2	DW12ATED (4HX), DW12ATED (4HZ), DW12ATED4 (4HW), DW12UTD (4HY), DW12ATED4 (4HP), DW12ATED4 (4HT), DW12ATED4 (4HR), DW12ATED4 (4HS)

Our products are designed to be used correctly and with care for the purpose for which they are intended. No liability is accepted by Sonic for incorrect use of any of our products, and Sonic cannot be held responsible for any damage to personnel, property or equipment when using the tools. Incorrect use will also invalidate the warranty.

If applicable, the applications database and any instructional information provided has been designed to offer general guidance for a particular tool's use and while all attention is given to the accuracy of the data no project should be attempted without referring first to the manufacturer's technical documentation (workshop or instruction manual) or the use of a recognised authority such as Autodata.

It is our policy to continually improve our products and thus we reserve the right to alter specifications and components without prior notice. It is the responsibility of the user to ensure the suitability of the tools and information prior to their use.



Instructions

Engine Timing & Rebuild Set
PSA, Fiat DW10, DW12 - 2.0, 2.2



829041 - Engine Timing & Rebuild Set

Description:

The 829041 kit brings together the tools required to set the valve timing on the extensive range of DW10 2.0 and DW12 2.2 Diesel engines as well as the DV4 1.4 and DV6 1.6 diesel engines found across the PSA and Fiat ranges.

Components

Ref	Comp	OEM	Description
1	4880072	7099-TM	Crankshaft Pin
2	4880112	0188K, 0132AK, 0153AK, 0187J, 4533-TAD	Timing Belt Retaining Clip
3	4880113	0188P, 7015-T, 0188P2	Puller
4	4880068	303-1059	Crankshaft Timing Pin
5	4880080	0188AH	Centraliser Spring
6	4880106	0188F	Flywheel Lock
7	4880108	0188J2	Tension Adjusting Tool
8	4880097	0188M	Locking Pin (8mm Dia x 60)
9	4880227	0188Q2	2mm Tensioner Locking Pin Long
10	4880228	0153AL	3mm Tensioner Locking Pin
11	4880060	0188Q1	4.0mm Auxiliary Tensioner Pin
12	4880104	0188J/J1	Tension Adjusting Tool
13	4880096	0189B	Locking Pin (8mm Dia, 70 Long)
14	4880090	0178D, 303-732, 0194A	Setting Pin 5.0mm (5 x 50)
15	4880064	303-734, 0194C	Flywheel Locking Pin (12 x 55)
16	4880255	0.532Y, 9967.34	8mm Flywheel Timing Pin

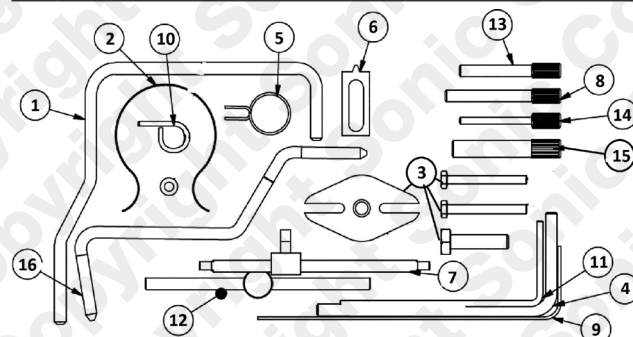

Instructions

The following instructions are for guidance only. Please refer to OEM derived data such as the vehicles manufactures own data or Autodata. The use of these engine timing tools is purely down to the user's discretion and Sonic cannot be held responsible for any damage caused what so ever.

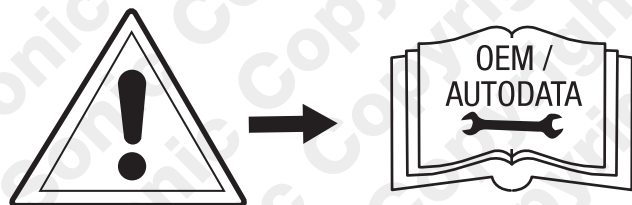

Instructions

Components 1, 4, 15 & 16 - Flywheel Locking Timing Pin.

Components 1, 4, 15 & 16 are used to set the crankshaft in its timed position by locking the Flywheel as shown.

NOTE: do not torque against component 1, 4, 15 or 16, use component 6.

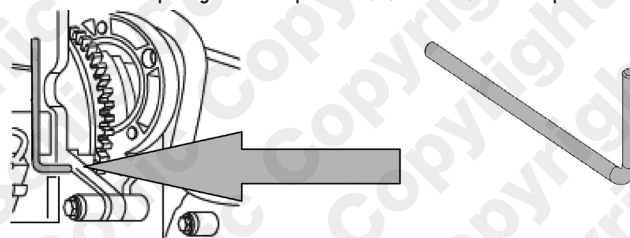

Component 2 - Timing Belt Retaining Clip.

Component 2 is used to hold the new belt in place on the crankshaft while fitting the belt around the camshaft pulleys.

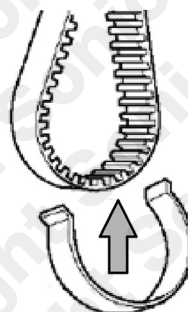

Component 3 - Crankshaft Pulley Puller

NOTE: Ensure threads well lubricated with Molybdenum Disulphide grease

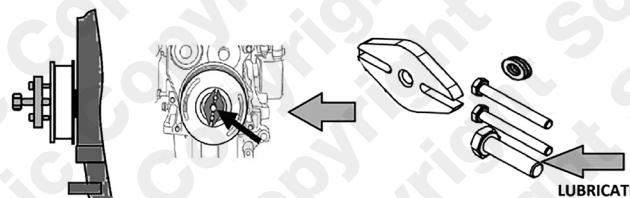

Component 5 - Centraliser Spring.

Component 5 is used to centralise the crankshaft cam belt sprocket when refitting it.

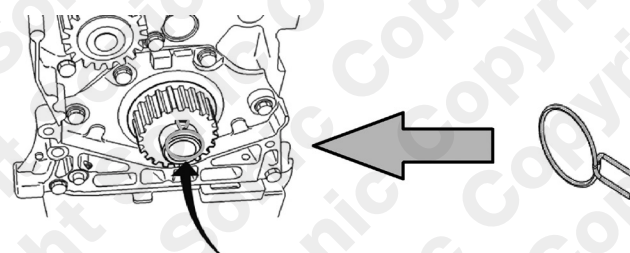

Component 6 - Flywheel Lock (Citroen/Peugeot)

Component 6 is used to lock the flywheel while tightening or loosening the crankshaft front pulley (PSA vehicles).

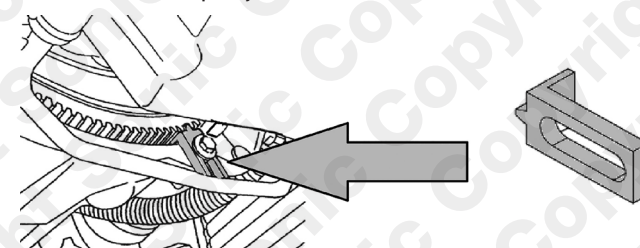

Components 7 & 12 - Tensioner Adjuster tools

Always refer to OEM data when setting belt tension.

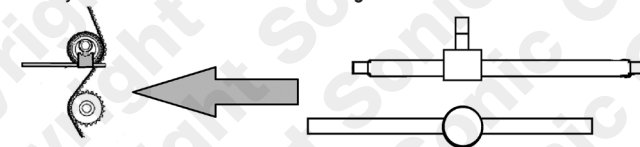

Components 8, 13 & 14 - Camshaft Locking pins

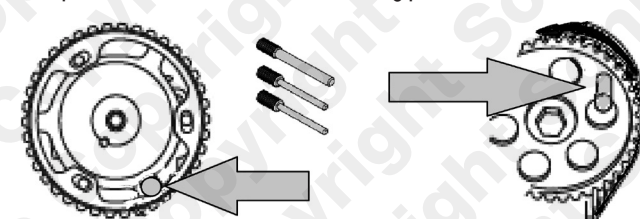

Component 9, 10 & 11 - Tensioner Locking Pins

